



**DELONGHI
MULTICOLUMN
HORIZONTAL**



DELONGHI MULTICOLUMN HORIZONTAL



50 Δ t

(75/65/20°C)

Height mm	Length mm	UIN	Number of Sections	2 COLUMN		3 COLUMN		4 COLUMN	
				Output dt50 Watts	Output dt50 Btu/hr	Output dt50 Watts	Output dt50 Btu/hr	Output dt50 Watts	Output dt50 Btu/hr
500	1038	763008	22	-	-	1135	3873	-	-
	1222	763013	26	1165	3975	-	-	-	-
	1406	763014	30	1344	4586	-	-	-	-
	1222	763018	26	-	-	1581	5395	-	-
600	624	763019	13	-	-	-	-	1054	3596

Δ t50 is the UK's industry standard for heating outputs, which has an operating temperature of 75/65/20°C. If you have a low temperature heat source you may wish to consider Δ t40 or Δ t30 output (see your installer or system designer or download from www.stelradprofessional.com).

Due to production tolerances, the length of the product and therefore the tap centres could contain a variation of +/- 1.5% of the overall stated length.

For EN442 data, technical and installation information please visit our website: www.stelradprofessional.com and search product downloads.



www.stelradprofessional.com

Telephone: 0800 876 6813

DE'LONGHI MULTICOLUMN HORIZONTAL



CLASSIC COLUMN HORIZONTAL FLOOR MOUNTING BRACKETS

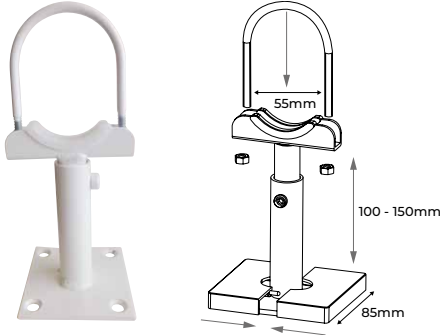

UIN 148137 White
(sold in pairs)

TUBE DIMENSIONS – 2 COLUMN

25mm Vertical round tubes.

Dimensions are in millimeters (mm)

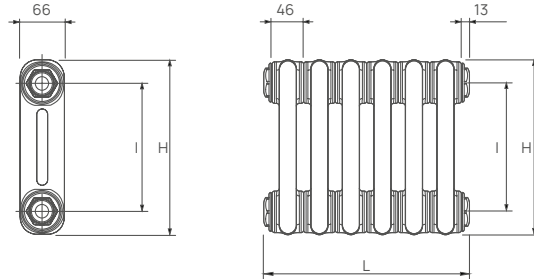

H: height
I: pipe centre (H-70)
L: lengths with fitted connections elements x 46 + 26

TUBE DIMENSIONS – 3 COLUMN

25mm Vertical round tubes.

Dimensions are in millimeters (mm)

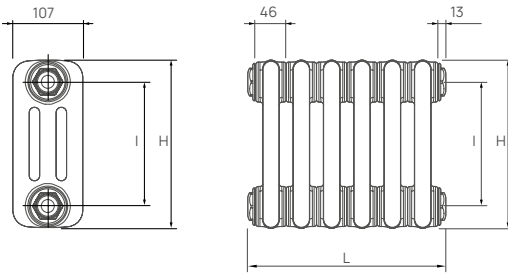

H: height
I: pipe centre (H-70)
L: lengths with fitted connections elements x 46 + 26

TUBE DIMENSIONS – 4 COLUMN

25mm Vertical round tubes.

Dimensions are in millimeters (mm)

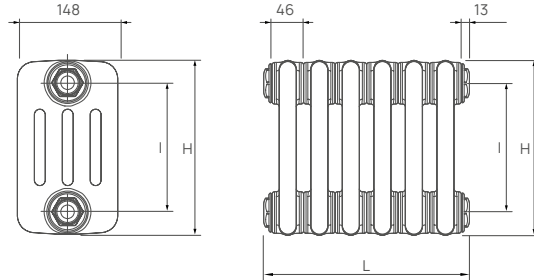

H: height
I: pipe centre (H-70)
L: lengths with fitted connections elements x 46 + 26

CONNECTIONS

Each radiator comes with 1/2" inlet connections as standard.

PIPING OPTIONS

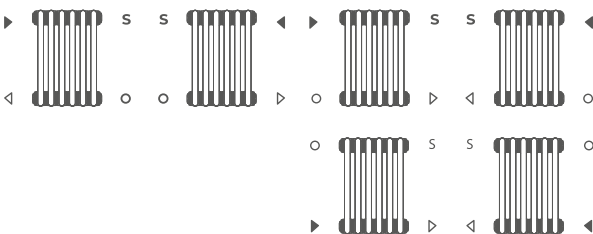

EN 442 CERTIFICATION DATA – CETIAT TESTED IN ACCORDANCE WITH BS EN 442

Type	2 Columns	3 Columns	4 Columns
Height	600	500	600
W/m at 75/65/20	974	1122	1322
n-coefficients	1.26	1.26	1.27
Weight (kg/m) - Elements	19.57	21.74	28.26
Water contents (l/m)	15.22	17.39	23.93
Wall to tap centre (mm)	63 / 73	84 / 94	84 / 94